

Advantek II - Ultra

DESCRIPTION

- Two stage
- 120 volts
- 5.7"/145 mm diameter
- Double ball bearings
- Single speed
- Thru-flow discharge
- Thermoset fan end bracket
- Stamped steel end bracket

DESIGN APPLICATION

- Equipment operating in environments not requiring separation of working air from motor ventilating air
- Designed to handle clean, dry, filtered air only

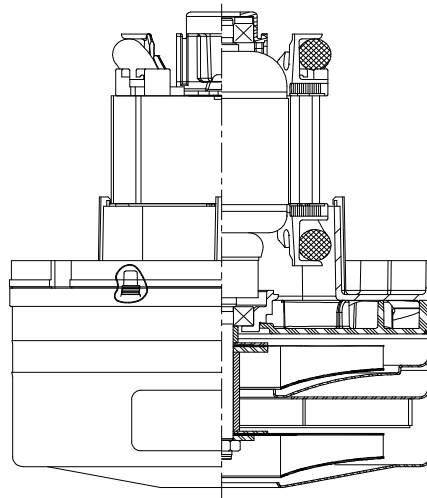

SPECIAL FEATURES

- **650 Peak Air Watts**
- Patented Advantek II diffusion
- 3" Commercial Lamination
- Dual Tapered fan system
- Provision for grounding
- Top end mounting boss
- Thermal Device
- UL recognized, category PRGY2 (E47185)
- Suitable for 120 volt AC operation, 50 or 60 Hz
- The Lamb vacuum motor line offers a wide range of performance levels to meet design needs

PEAK AIRWATTS
650
Calculated in accordance with ASTM F2105

TYPICAL MOTOR PERFORMANCE.*

(At 120 volts, 60Hz, test data is corrected to standard conditions of 29.92 Hg, 68° F.)

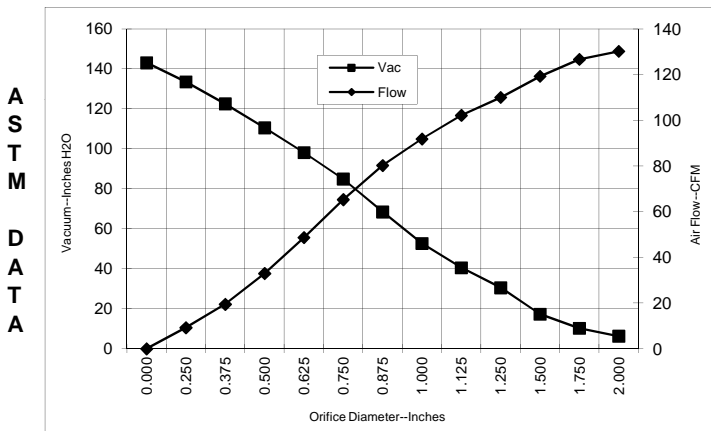

Orifice (Inches)	Amps	Watts (In)	RPM	Vac (In.H2O)	Flow (CFM)	Air Watts
2.000	15.0	1689	25702	6.3	130.2	97
1.750	14.7	1654	25702	10.2	126.6	153
1.500	14.6	1648	25319	17.3	119.3	243
1.250	14.9	1680	25309	30.6	110.0	395
1.125	14.5	1632	25693	40.5	102.2	486
1.000	14.3	1608	25693	52.7	91.8	568
0.875	13.9	1569	26076	68.4	80.2	645
0.750	13.5	1523	26853	84.9	65.3	650
0.625	12.3	1391	27630	98.1	48.7	561
0.500	11.1	1270	28780	110.5	32.9	428
0.375	10.0	1144	30727	122.5	19.5	280
0.250	9.1	1029	32281	133.5	9.2	144
0.000	9.0	935	33834	143.1	0.0	0

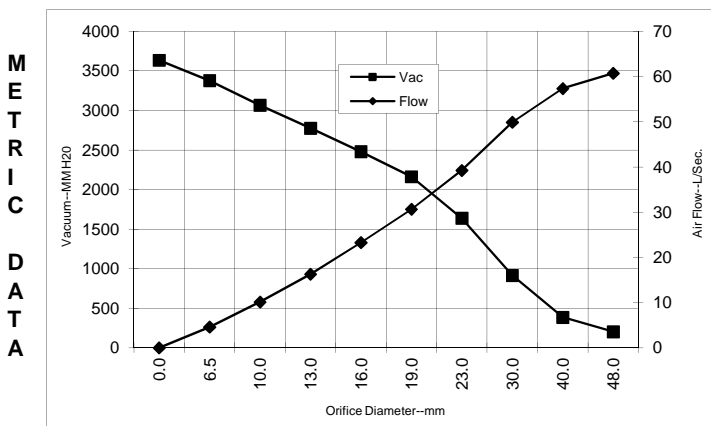

Orifice (mm)	Amps	Watts (In)	RPM	Vac (mm H2O)	Flow (L/Sec)	Air Watts
48.0	14.8	1674	25702	204	60.7	122
40.0	14.7	1650	25434	386	57.3	216
30.0	14.7	1654	25520	915	49.9	445
23.0	14.0	1578	25980	1639	39.2	626
19.0	13.4	1520	26868	2163	30.7	648
16.0	12.3	1396	27599	2479	23.3	564
13.0	11.3	1282	28665	2775	16.3	441
10.0	10.2	1163	30435	3066	10.1	303
6.5	9.1	1034	32203	3377	4.6	151
0.0	9.0	935	33834	3634	0.0	0

Note: Metric Performance data is calculated from the ASTM data above.

* Data represents performance of a typical motor sampled from a large production quantity. Individual motor data may vary due to normal manufacturing variations.

Test Specs: 120 volts	Minimum Sealed Vacuum: 130"	ORIFICE: 7/8 "	Minimum Vacuum: 61"	Maximum Watts: 1605
-----------------------	-----------------------------	----------------	---------------------	---------------------

